

LEGEND - PROPERTY SERVICE CONNECTIONS

- W** **WATER** - POLY SERVICE FROM WATER MAIN, METER BOX & COVER INSTALLED. BUILDER TO MAKE APPLICATION TO LOGAN CITY COUNCIL FOR METER ASSEMBLY SUPPLY AND INSTALLATION. WHERE WATER METER IS LOCATED BEHIND RETAINING WALL, 25mm POLYPIPE WILL BE SUPPLIED UNDER WALL INTO LOT AND WILL BE MARKED WITH 900X50X25 HW STAKE LABELLED "WATER".
- S** **SEWER** - CAPPED Ø100 PVC PIPE (BURIED MAX 1.5m). MARKED WITH 40Ø ORANGE PVC CONDUIT AT SURFACE (BURIED TO CAPPED PIPE). CONDUIT LABELLED "SEWER."
- RW** **ROOFWATER** - CONNECTION LOCATION CAN BE EITHER FRONT OF LOT VIA KERB ADAPTOR OUTLET TO ROAD, OR REAR OF LOT INTO ROOFWATER DRAINAGE PIPE VIA PIT. CAPPED PVC Ø100 PIPES (BURIED MAX 1.5m) MARKED WITH 900X50X25 HW STAKE LABELLED "ROOFWATER."
- SSD** **RETAINING WALL SUB-SOIL DRAINAGE** - OUTLET POINT TO LOT FOR RETAINING WALL SUB-SOIL DRAINAGE TO BE CONNECTED TO YARD DRAINAGE BY BUILDER. Ø100 NON-SLOTTED AGG PIPE CAPPED AND TERMINATED 200m ABOVE SURFACE. PVC DUCT TAPED TO 900X50X25 HW STAKE LABELLED "RETAINING WALL SUBSOIL OUTLET".
- T** **TELECOMMUNICATIONS/NBN** - PVC CONDUIT (BURIED APPROX 300mm). MARKED WITH 900X50X25 HW STAKE LABELLED "TELECOMMS".
- E** **ELECTRICITY** - ELECTRICITY PILLAR EXISTS IN ROAD VERGE. BUILDER TO MAKE APPLICATION WITH ENERGY PROVIDER FOR SERVICE INSTALLATION TO LOT. WHERE ELECTRICITY PILLAR IS LOCATED BEHIND RETAINING WALL, CONDUIT WILL BE SUPPLIED UNDER WALL INTO LOT AND WILL BE MARKED WITH 900X50X25 HW STAKE LABELLED "ELECTRICITY".
- G** **GAS** - GAS MAIN EXISTS IN ROAD VERGE. BUILDER/HOME OWNER TO MAKE APPLICATION TO GAS PROVIDER FOR SERVICE INSTALLATION TO LOT.
- RETAINING WALL**
- SERVICE TERMINATION POINT MARKER.** 900X50X25 HW STAKE, OR 40Ø ORANGE PVC CONDUIT STAKE

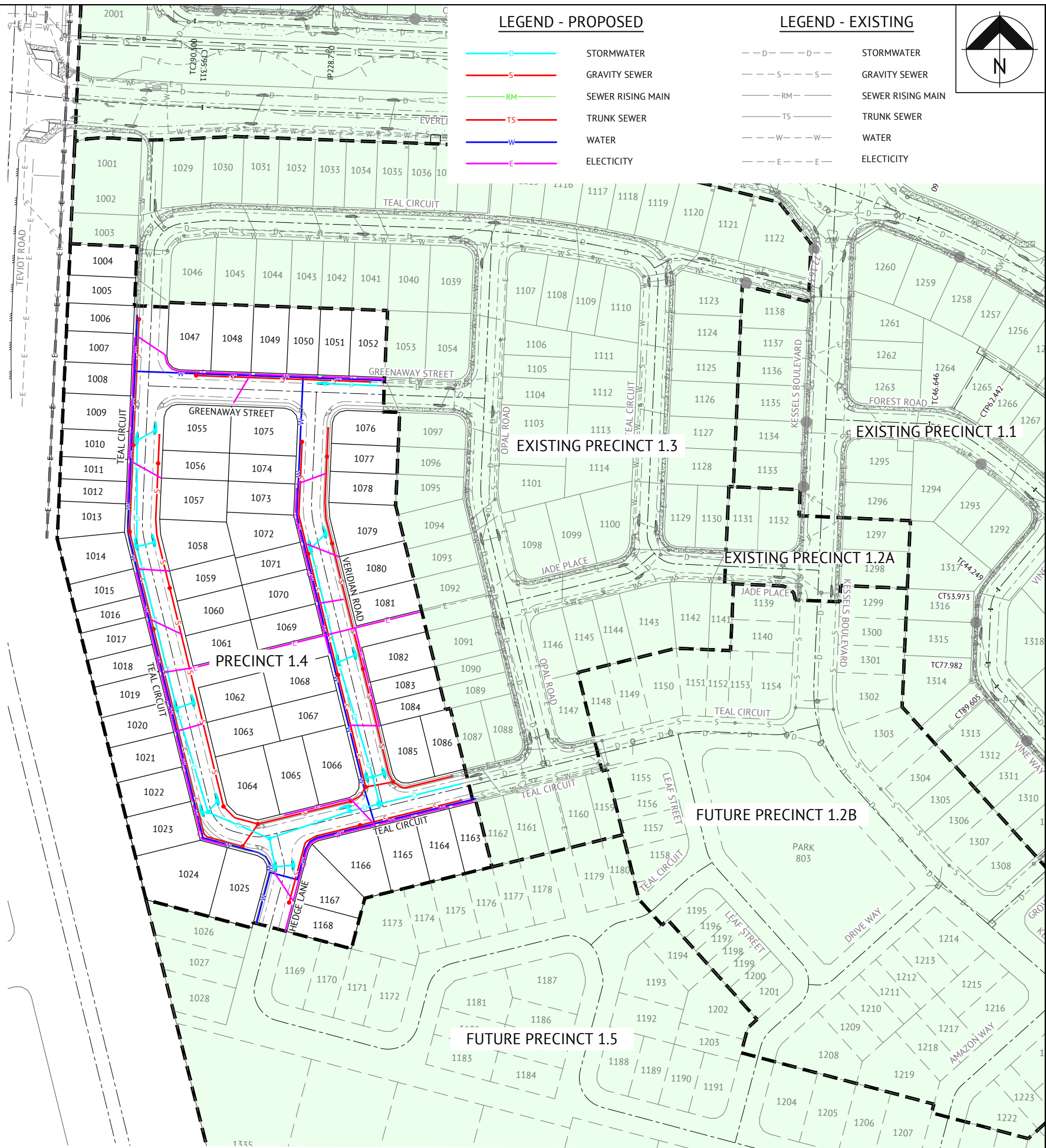

| DATE | REV | DESCRIPTION | REVISIONS |
|----------|-----|--|-----------|
| 19/12/19 | B | UPDATED PROJECT DIRECTOR AND RPEQ DETAILS - NO ADDITIONAL DESIGN AND DRAFTING AMENDMENTS | JS |
| 02/07/18 | A | ORIGINAL ISSUE | KH |

Premise

BRISBANE OFFICE
LEVEL 1, 100 BRUNSWICK STREET
PO BOX 361
FORTITUDE VALLEY, QLD 4006
PH: (07) 3253 2222
WEB: www.premise.com.au

DESIGNED: MICHAEL MAJZNER
CHECKED: MICHAEL MAJZNER
PROJECT MANAGER: JOSHUA STONE
PROJECT DIRECTOR: JOSHUA STONE

DATE: 19/12/19

RPEQ: JOSHUA STONE
SCALE: 0 20 40 60m
SCALE 1:1000 (A1)

CLIENT: MIRVAC

PROJECT: EVERLEIGH PRECINCT 1.4 SUBDIVISION DEVELOPMENT

LOCATION: TEVIOT ROAD, GREENBANK

SHEET TITLE: OVERALL SERVICES LAYOUT

JOB CODE: MIR001-04

SHEET NUMBER: C003

REV: B