

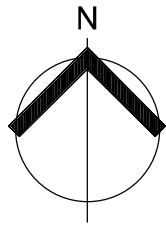

Everleigh



LEGEND

- Area of Fill
  - Area of Cut
  - Design Contours
  - Depth of Fill Contours
  - Proposed Retaining Wall
  - Proposed Tiered Retaining Wall
  - Proposed Earthworks Pad
  - Finished Pad Design Level
  - Finished Surface Design Level
- (Not all items in this legend may be relevant to the lot shown hereon)

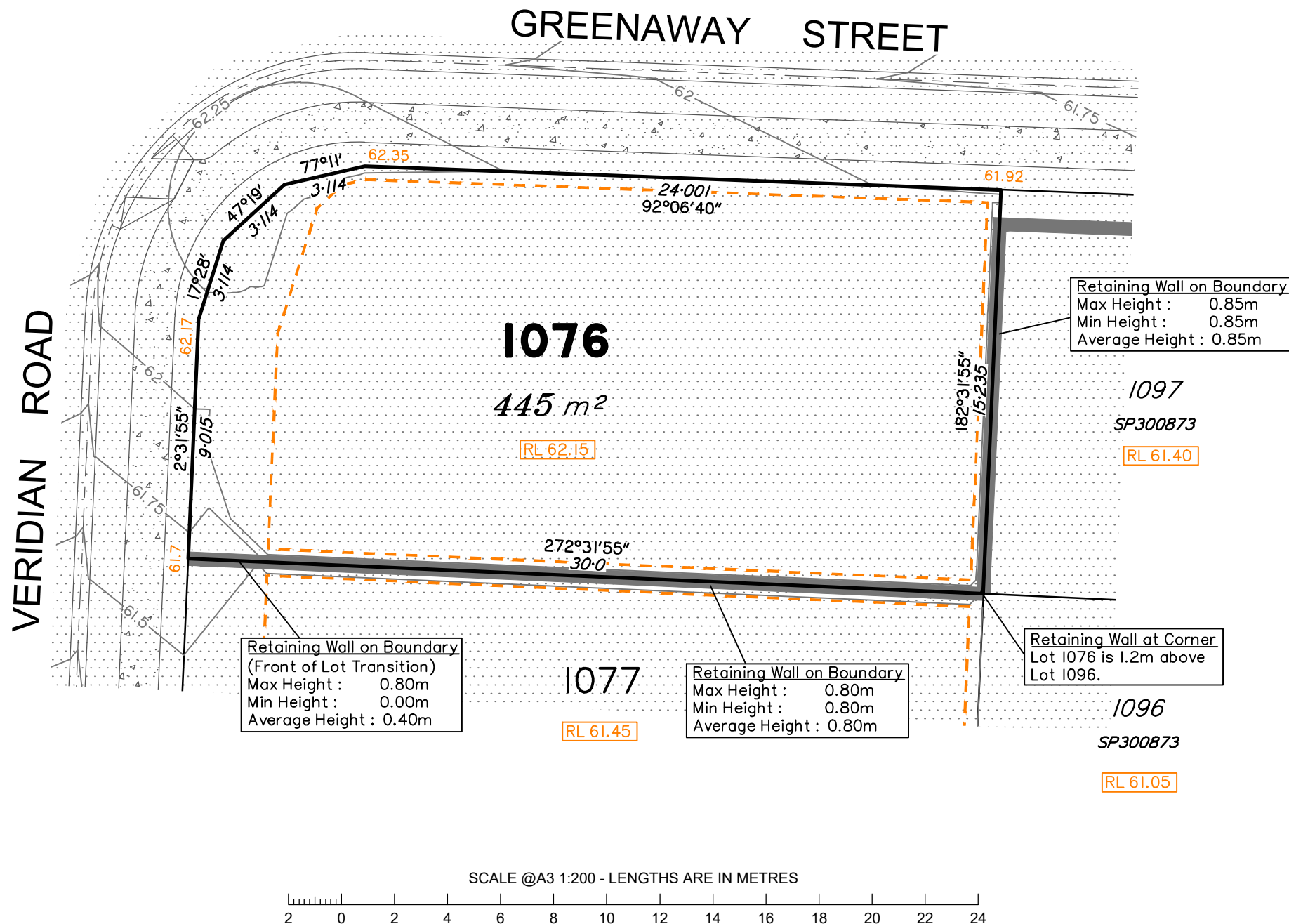

NOTES

- This plan has been prepared from preliminary survey plan (SP300874) and engineering plans provided on the 20/11/2019 by Premise Engineering Pty Ltd.
- Development approval was granted for this subdivision (DEV2016/768/35) by the Minister for Economic Development Queensland (04/07/19).
- The relevant authorities have granted operational works approval, for the proposed lot.
- Extent of retaining walls shown indicatively only. Retaining walls may not extend the full length of a lot boundary where finished level between allotments is less than 0.5m.
- The purchaser should refer to the applicable development approvals for building and/or other requirements that may be applicable to the lot.
- Parts of this lot may be subject to rip and re-compact earthwork procedures as determined by site conditions. This process may be completed in cut locations to assist the house pad construction. Any re-compaction will comply with AS3798 requirements and certified by a third party company.

Issues	No.	by	Date	Description
	A	TBG	11/12/19	Original Issue